

# TOSHIBA

## A4 SIZE BUT A3 FEATURES

**e-STUDIO2822AF**



**TOGETHER  
INFORMATION**

# A4 SIZE BUT A3 FEATURES

The new e-STUDIO2822AF is a compact A4 size multi-function product with A3 capabilities that are perfect for small to medium-sized offices. Printing at 28 pages per minute, the device is equipped with versatile functions that not only meet but exceed your expectation.

It offers one of the lowest Total Cost of Ownership in this category and durability is further enhanced by its long-life design that also makes the machine more reliable.



## CONVENIENT OFFICE APPLICATIONS

### > ID Copy

Copy both sides of the card onto single side paper, saving time & paper. This eliminates the time consuming steps of manually flipping the paper for copying the other side of the card.

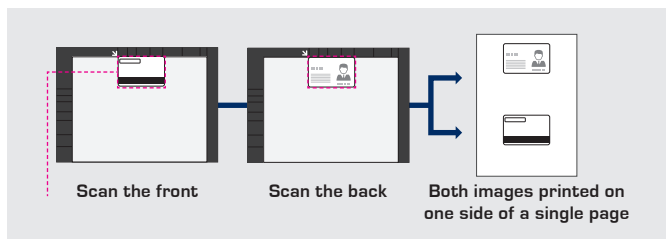

### > Scan to USB/Email/Folder

Scanned file can be stored directly onto USB drive with greater convenience.

Scan-to-email/folder reduce the cost of hardcopy distribution, saving cost and time.

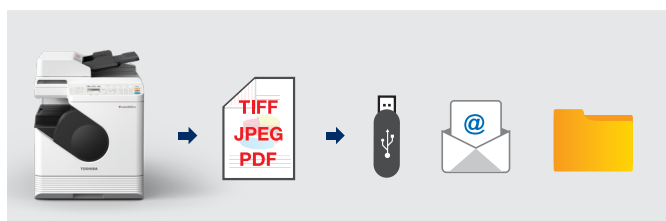

### > Compact A4 Size

A3 capabilities in a compact A4 footprint that gives you flexible functions without compromising on workspace.

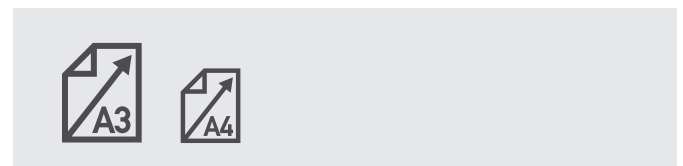

### > Universal Print Driver

Unified access to any print device, simplifies printing with enhanced convenience.

### > USB Direct Print

Image files stored in USB flash drive can be printed with just a touch of a button.



## > Security User/Device Management

Ease in device/user management with the use of department codes via TopAccess.



## > Cloud & Mobile Applications with e-BRIDGE Print & Capture

Intuitive and yet simple connection to MFP that allows user to print/scan easily via mobile device.

Print directly from mobile device to Toshiba MFPs. Scan file directly to Google Drive, Dropbox, OneDrive.



## > WiFi

Seamless connection to the MFP via WiFi option. This function allows mobile devices to connect to MFP directly.

## > e-Bridge Cloud Connect

Cloud based system that provides proactive service which will improve service up time, reduce workload and keep MFP up-to-date.



### Beware of Imitation or Remanufactured Parts and Supplies.

Only Toshiba genuine parts & supplies are compliant to the RoHS directive & MSDS certified. Even though they may say "for use in Toshiba," or "equivalent reliability and performance", third party supplies can't match Toshiba's exacting quality standards. They don't undergo Toshiba's stringent qualification and rigorous testing to ensure that all components work together in perfect harmony. Plus, they void your warranty. Be Smart. Be Safe. Always purchase from an Authorised Toshiba Distributor so you can be sure you're not inadvertently installing imitation/remanufactured supplies, which can shorten product life, hamper productivity, and irrevocably damage your Toshiba equipment.

**SPECIFICATIONS**
**e-STUDIO2822AF**
**GENERAL**

Print & Copy Speed	28 cpm
Warm-up Time	Approx. 18 sec
Paper Capacity (Standard)	Drawer x 1 : Max paper 250 sheets. Stack Feed Bypass Max 50 sheets
Max. Paper Capacity	300 sheets
Processor	Cortex A8 500MHz
Memory	512MB
Dimension	W 390 x D 540 X H505 (mm)
Power Consumption	Max 1.5kW (220 - 240V)

**COPY**

Max Original Size	A3 (A4 on platen glass)
First Copy Outtime	Less than 6.4 seconds
Multiple Copy	1 - 999 copies/Ten key input
Zoom	25% to 400% (1% increment)
Copy Mode	Text, Text/Photo(Default), Photo

**PRINT**

Printing Resolution	2400 dpi x 600 dpi (with smoothing)
Page Description Language	PCL5e/PCL5c/PCL6 (PCL XL)
Operating Systems	Windows 7 (32/64 bit) (SP1 Recommended)
	Windows 8.1 (32/64 bit)
	Windows 10
	Windows Server 2008 SP2 (32/64 bit)
	Windows Server 2008 R2 SP1 (64 bit)
	Windows Server 2012/R2 (64 bit)
	Windows Server 2016
Redstone5	
Interface	RJ45/USB2.0

**SCAN**

Scan Resolution	600 dpi x 600 dpi
Scan Speed	Up to 25 spm
Supported Destination	File Server/SMB/FTP, Scan to File, Scan to Email

**FAX**

Compatibility	Super G3 / G3
Data Compression Method	JBIG, MMR, MR, MH
Modem Speed	33.6 kbps - 2.4 kbps (Auto fallback)
Transmission Speed	Approx. 3 sec

**OPTIONS**

Wireless LAN Module	GN-1160
Co-packed Toner	2,000 (Yield)
Black Toner	6,000 (Yield) / 17,500 (Yield)

For more information and a complete list of MFPs and Solutions, please contact us:

**Toshiba TEC Singapore Pte Ltd**

2 Ang Mo Kio Street 62

Singapore 569138

Tel : (65) 6481 9488

Fax : (65) 6481 2385

Distributed by

Technical data is subject to change without prior notice. All company and/or product names are trademarks and/or registered trademarks of their respective manufacturers in their markets and/or countries. All rights reserved. We are constantly making efforts to deliver the latest status of data to our partners. Specifications for some models may change in the time between the production and the release of this documentation. Productivity and paper specifications are related to paper size of A4 and a paper weight of 80 g/m<sup>2</sup> if not otherwise mentioned.

Copyright ©2019 TOSHIBA TEC.

TSE Version 01